

MANUAL

This is a precision instruction, please make sure you read this carefully before you try your first ride.
If you doubt about any information inside this instruction, please contact us or your local distributor.

Meet your E-bike

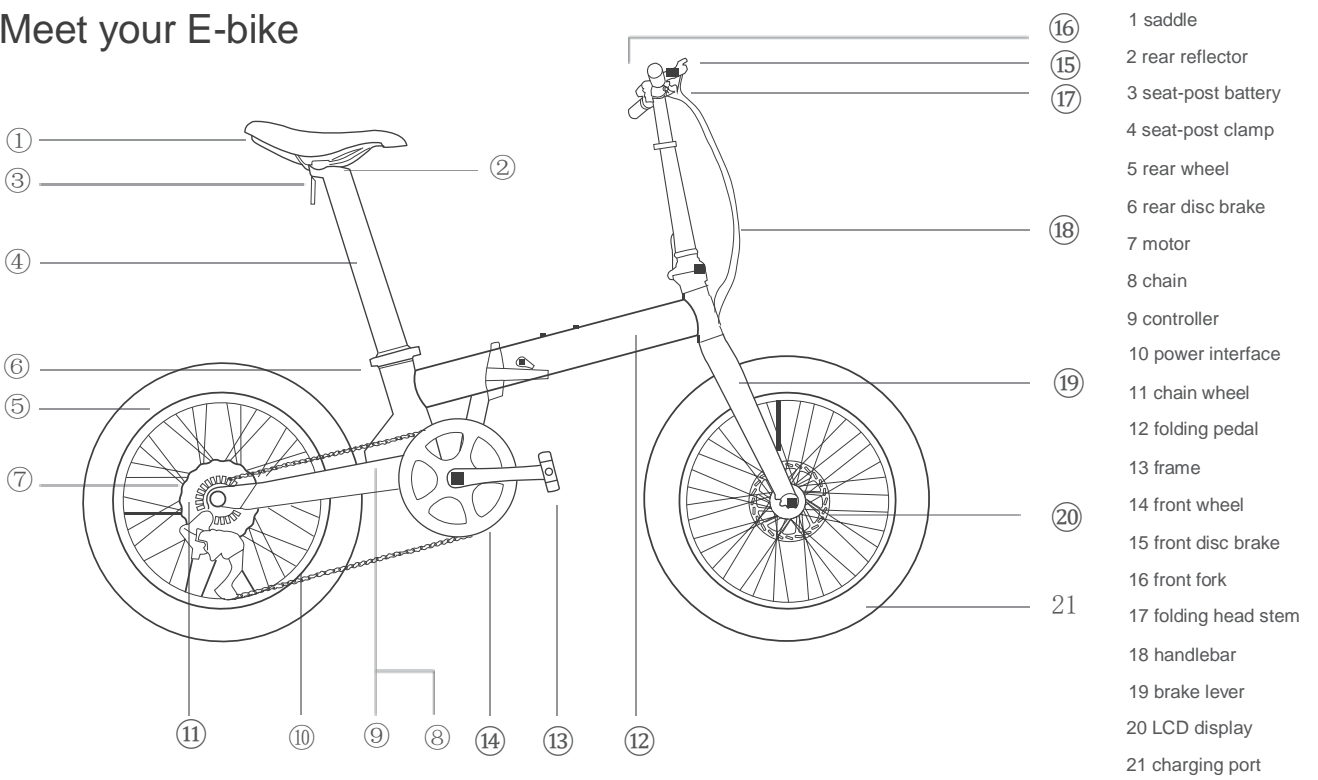

Fold your Ebike

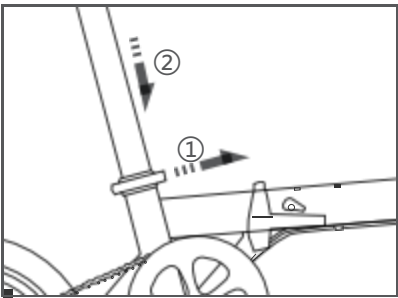

1. grab the seat-post (important). loose the clamp.
2. Push the seat-post till the end slowly, tight the seat-post clamp.

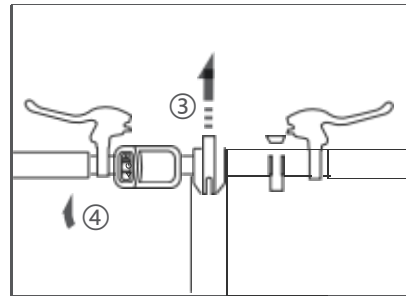

3. loose the handle bar clamp.
4. turn the handlebar clockwise till vertical, tight the clamp.

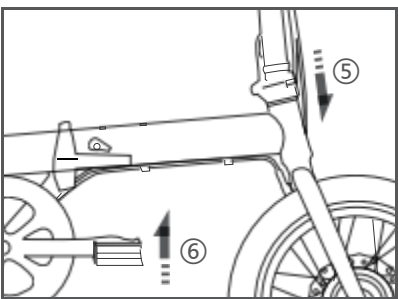

5. release the lock clamp, fold the head tube.
6. fold the pedal by pushing it level.

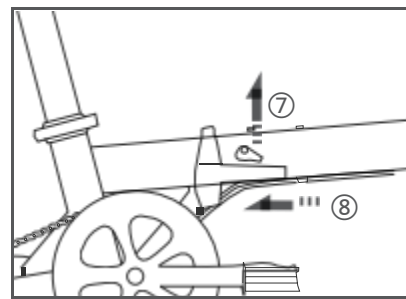

7. release the safety cap.
8. pull the lock bar, fold the main tube.

Operate your E-bike

I Press & hold Mode button for 3 sec, LCD shows screen I , data shows as: current speed – total range - PAS class – battery capacity;

II Press power button, LCD Shows screen II , data shows as: current speed - single range – PAS class – battery capacity;

III Press power button twice, LCD shows screen III , data shows as: current speed – battery voltage – PAS class – battery capacity

Touch & hold power button to turn off

+ Plus

M Mode & Power

- Minus

☰ light



Slide mode



I



II



III

1.Slide mode: press & hold DOWN button till the person icon flicker, your E-bike will slide at a fixed speed of 6KM/H, release to quit.

2.Throttle mode: ride your E-bike to be over 7KM/H, then press & hold throttle, the bicycle will run at a fixed speed(Eco 15km/h, Mid 20km/h, High 25km/h), take break or release the throttle to quit.

3.Light: press & hold + button to turn on backlight, press & hold UP button again to turn off.

4.PAS mode: press + or - button to choose PAS classes from eco ~ middle ~ high.

Charge your E-bike

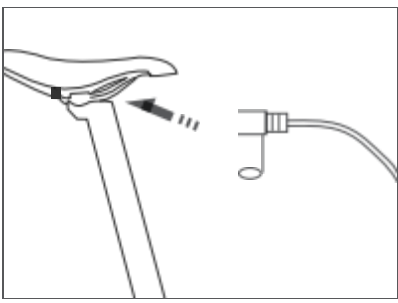

Charging port is on the upper right of the battery box , covered by a rubber dust-free cover, uncover it, plug the charger into the port; cover the port again when charged.

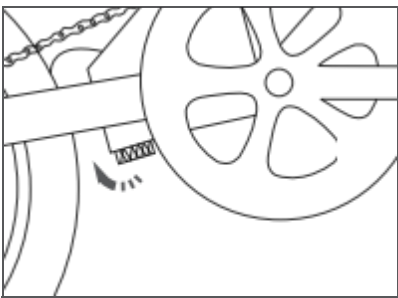

If you want to charge your battery separately, loosen the battery connector, lift the saddle & pull out the battery, then repeat the steps above.

Accessory list

1 Front Mud Fender

2 Rear Mud Fender

3 Rear Rack

4 Front Basket

5 Reflectors

6 Ring

7 Lamp

8 Rear Light

Please mount accessories according to your needs.

Attention

Battery & Charge

- 1.Red indicator on the charger means charging, when it turns green, please stop charging your battery;
2. Do not expose to temperature $-20^{\circ}\text{C} < \text{ or } > 35^{\circ}\text{C}$, Fully charge the battery and store separately if not use for over 30 days. Fully charge it every 60 days, or the battery may self-discharge and be damaged. This damage is not covered by the Limited Warranty;
- 3.Never expose your battery to damp environment or soak into water, never short circuit the battery terminals, This damage is not covered by the Limited Warranty;
- 4.Charge with the original charger only;
- 5.Do not disassemble/punch battery pack. Do not place it in fire or drop from high, avoid contacting with contacts;
- 6.Turn off E-bike' s power before charge it. Plug the charge port first then the AC plug;
- 7.Do not cover any items on the charger during charging;
- 8.Pull out charge port before the AC plug;
- 9.Please keep battery outreach from children.
- 10.The capacity of Li-battery will decrease when $-10^{\circ}\text{C} <$;
- 11.Recycle or dispose of in accordance with local regulations.

Ride & Maintenance

- 1.Must with your helmet on and follow the local laws and regulations ;
- 2.Read this instruction carefully before riding an E-bike;
- 3.Start your ride with the ECO PAS class ;
- 4.Keep the lamp on at night ;
- 5.Fully check break system, tire pressure ,and battery remain before riding ;
- 6.PLEASE do take front break FIRST ;
- 7.Do not intense riding ;
- 8.Do not ride into water over 15cm ;
- 9.Replace the quick-wear parts(like break pad)in time ;
- 10.Juveniles\Pregnant\Intoxicated are not allowed to ride E-bike ;
- 11.Keep your E-bike away from damp, high temperature or corrosive environment ;
- 12.Keep your E-bike away from sun-scorched and rain-drenched ;
- 13.Check screws, chain and other parts regularly.